

FS-M9 ECO

INTESTATRICI
END MILLING MACHINE

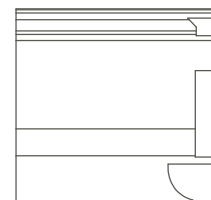

guarda il video
watch the video

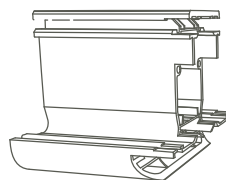

1. L'intestatrice **FS-M9 ECO** è adatta sia per profili in alluminio sia per profili in PVC ed ha un registro a giostra con differenti battute meccaniche a seconda del profilo.
2. Lo spostamento della testa è manuale ed il comando di avviamento motore è posto sull'impugnatura della leva.
3. A richiesta è possibile averla nella variante 90° - 45° Dx - 45° Sx ed angoli intermedi.



1. The **FS-M9** end milling machine is suitable for both aluminum and PVC profiles and has a carousel register with different mechanical stops depending on profile.
2. The head movement is manual and the engine start command is located on the handle of the lever.
3. On request it is possible to have it in the 90° - 45° right - 45° left and intermediate angles.

MISURE E CARATTERISTICHE TECNICHE MEASUREMENTS AND TECHNICAL CHARACTERISTICS

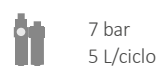
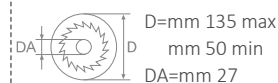
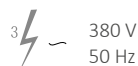
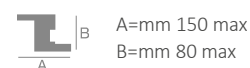

www.italplastick.com

FRESATRICI SCARICO ACQUA WATER SLOT MACHINES

END MILLING MACHINE

INTESTATRICI